

- Notes:
1. Material: TC-852, Cast Polyurethane, UL94V-2 Flammability Standard.
 2. Finish:
 1. Prime and Paint (see notes).
 2. Model has a 0.008-inch allowance for primer and paint thickness.
 3. Logo silk-screen information is on sheet 2. Artwork file is part number DNS-102924.
 3. Material shall comply with current RoHS requirements specified in SOP-100361
 4. SolidWorks model controls dimensions and tolerances, ± 0.005 feature to feature unless noted.
 5. Most all drafts are between 1.0 and 3.0-degrees per side.
 6. Volumne is 13.9 cubic-inches.
 7. See sheet two for silkscreen logo placment.

REVISIONS			
REV	DESCRIPTION	ECO	CHANGED BY
3	Changed flange ID.	1681	C Oostman
4	Fixed intersection of the two paint grooves	TBD	C Oostman

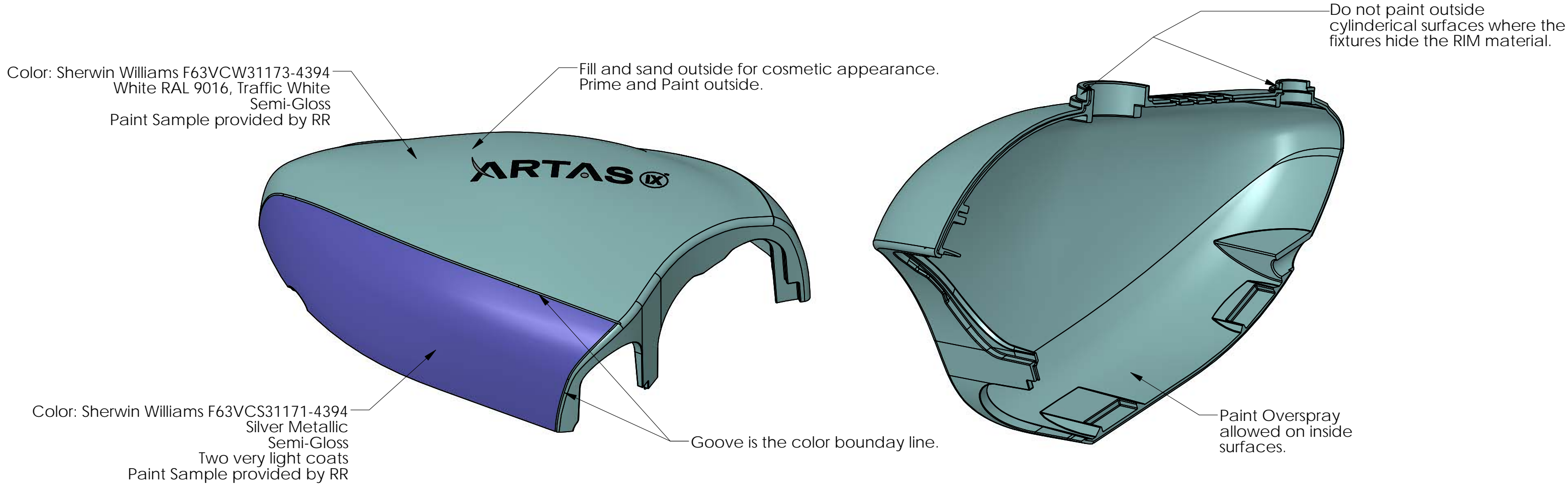

SolidWorks File: PRT-103447-R Gen-13 Cover Rightside

Confidential and Proprietary Data

<div>UNLESS OTHERWISE SPECIFIED DIMENSIONS ARE IN INCHES TOLERANCES ARE:</div> <table><tr><td>FRACTIONS $\pm 1/64$</td><td>ANGLES $\pm 0^{\circ} 30'$</td><td>DECIMALS .X $\pm .1$.XX $\pm .01$.XXX $\pm .005$</td></tr></table>	FRACTIONS $\pm 1/64$	ANGLES $\pm 0^{\circ} 30'$	DECIMALS .X $\pm .1$.XX $\pm .01$.XXX $\pm .005$	APPROVALS	DATE	<div> RESTORATION ROBOTICS</div> <div>128 Baytech Drive San Jose, CA 95134 (408) 883-6888</div>
	FRACTIONS $\pm 1/64$	ANGLES $\pm 0^{\circ} 30'$	DECIMALS .X $\pm .1$.XX $\pm .01$.XXX $\pm .005$			
	DESIGNED BY C Oostman	2/26/2019				
	DRAWN BY C Oostman	3/6/2019				
MATERIAL See Notes	APPROVED BY C Oostman	3/6/2019	Gen-13 Cover Rightside			
FINISH See Notes	<div></div>					
INTERPRET DIM AND TOL PER ASME Y14.5M-1994	THIRD ANGLE PROJECTION		SIZE B	DWG NO. PRT-103447-R	REV 4	
SCALE: 1:2		DO NOT SCALE DRAWING		SHEET 1 OF 2		

4

3

2

1

REVISIONS

SEE SHEET 1 FOR REVISION HISTORY

D

D

C

C

B

B

A

A

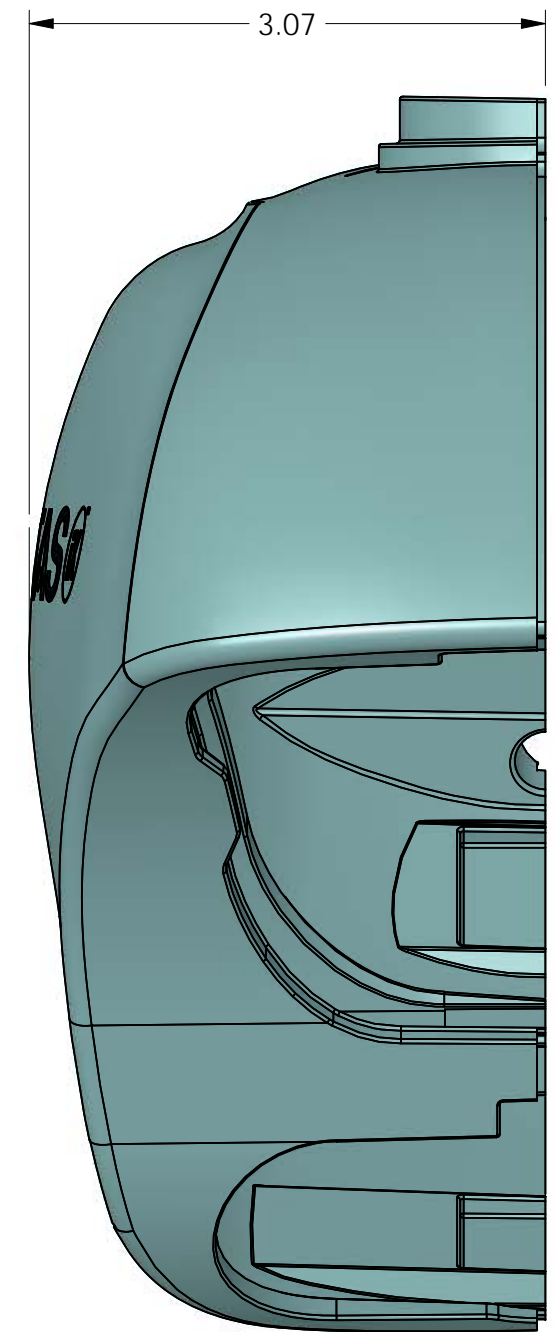
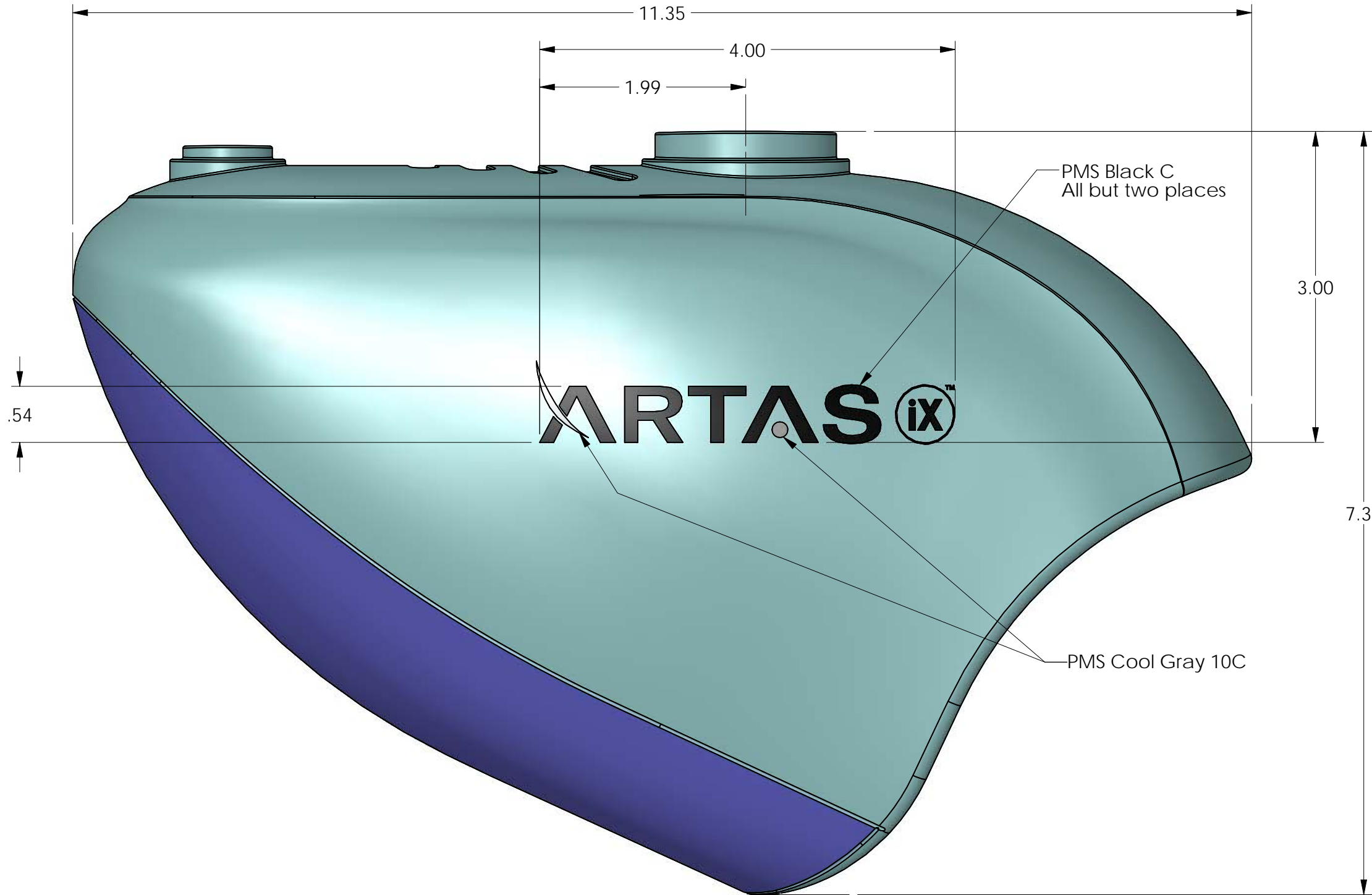

RESTORATION
ROBOTICS

128 Baytech Drive
San Jose, CA 95134
(408) 883-6888

Gen-13 Cover Rightside

SIZE
B

DWG NO.

PRT-103447-R

REV
4

SCALE: 7:8

DO NOT SCALE DRAWING

SHEET 2 OF 2

4

3

2

1